

CITY OF LAWRENCEVILLE, GEORGIA

DESIGNATION: 126

HEIGHT: 303.9563 METERS 997.230 FEET

S.P.C. GA. W.		NORTH	EAST	SCALE
	METERS	436,252.3029	715,919.5346	
	FEET	1,431,271.097	2,348,812.673	0.999903591

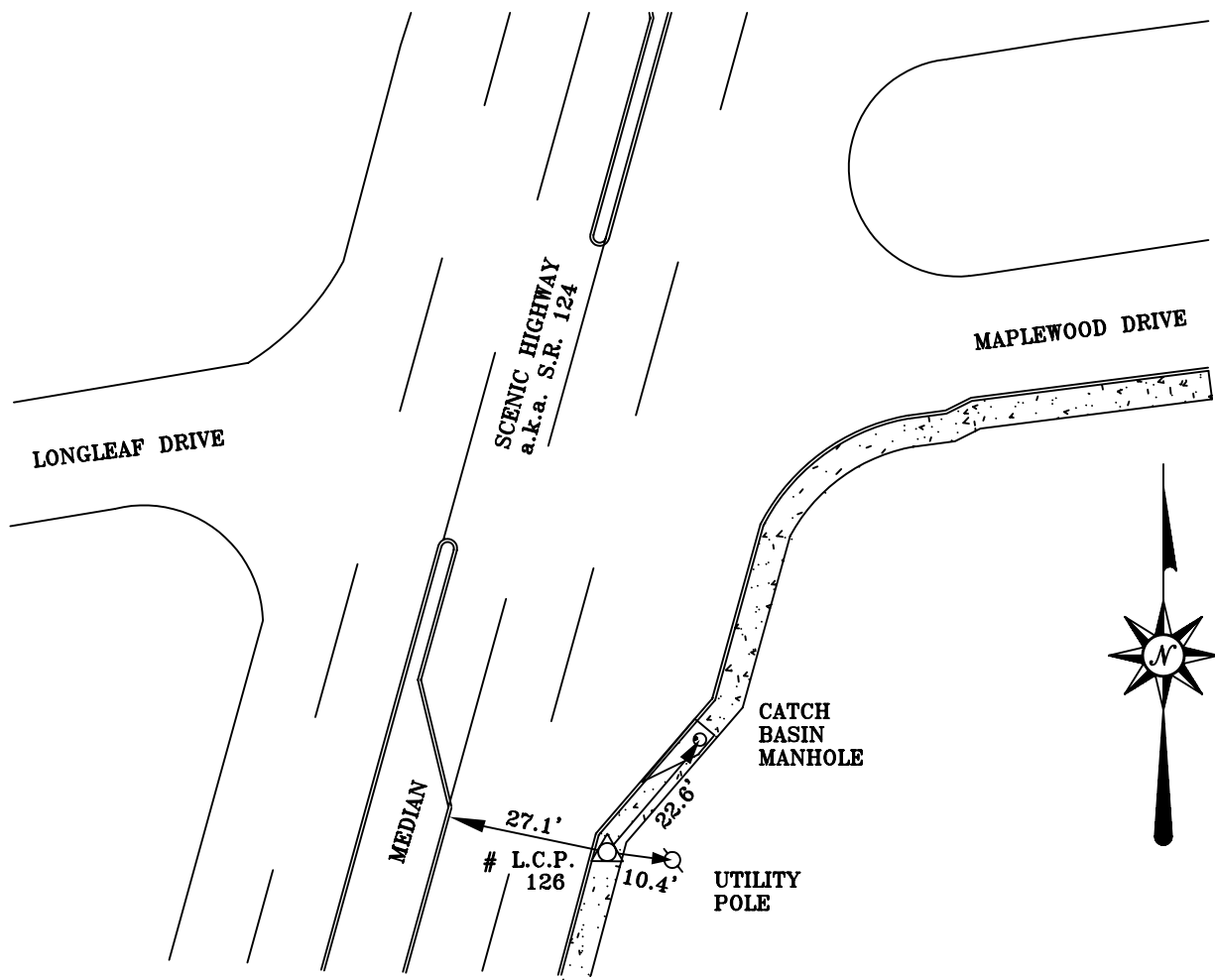

DESCRIPTION:
 THE STATION IS A BRASS DISC SET IN THE SIDEWALK ON THE EASTERLY SIDE OF SCENIC HIGHWAY (a.k.a. S.R. 124). THE STATION IS LOCATED NEAR THE START OF THE TAPER FOR THE DECELERATION LANE OF SCENIC HIGHWAY TO MAPLEWOOD DRIVE.

NTS



CITY OF
 LAWRENCEVILLE, GA.
 Telephone: (770) 963-5123

REFERENCE:
 LAWRENCEVILLE CONTROL POINT # 126